

Room Specification Plan...	
Pillar	■
Dual Socket	XX
Single Socket	X
High Level	HL
TV Point	●
32amp 3 phase 5pin socket	⊗

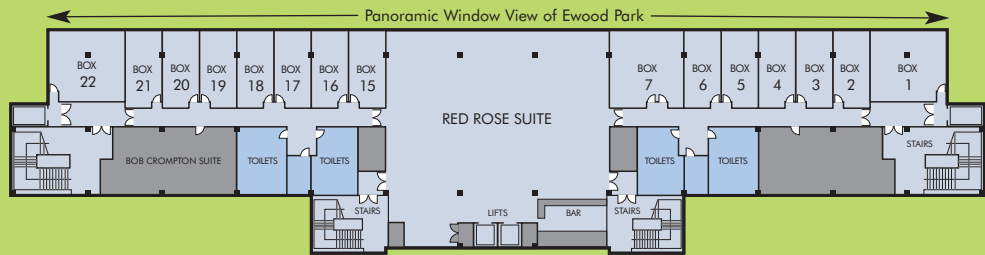

Red Rose Dimensions...		Red Rose Suite Specifications...			
20.85m x 12.54m (258 sq mtrs)		Lift Access	Yes	Telephone Points	1
Red Rose Capacities...		Natural Light	Yes	Wi-Fi	Yes
Theatre Style	150	Views of the Ground	Yes	Disabled Access	Yes
Classroom	100	Air Circulation System	Yes	Blackout Screens	No
Dinner	120	TV & Video Points	4	No of Bars Available	1
Dinner Dance	80	PA System	No	Dancefloor	Yes
		13 amp dbl sockets	16	Max Ceiling Height	2.7m
		3 Phased Electricity	No	Min Ceiling Height	2.2m
Bob Crompton Suite Dimensions...					
11.14 x 4.90					